



Carr. 869, Calle 4 Las Palmas Industrial Park, Cataño, Puerto Rico 00962

Tel. 787-641-2420

Sterling SSU1-27-12M One Door Mega Top Stainless Steel Refrigerated Sandwich Prep Table



Model: SSU1-27-12M

Technical Data

Width	27 1/2 Inches
Depth	35 Inches
Height	45 7/8 Inches
Power Cord Length	84 Inches
Cutting Board Width	27 1/2 Inches
Interior Width	24 Inches
Nominal Width	27 Inches
Right Door Opening Width	24 1/16 Inches
Cutting Board Depth	8 Inches
Interior Depth	23 3/4 Inches

Features

- Mega top accommodates (9) 1/6 size and (3) 1/9 size, 6" deep food pans
- Industry-best 3/4" cutting board is built-in for convenient prep space and removable for cleaning
- Digital control with auto defrost
- Stainless steel exterior and interior; foamed-in-place polyurethane insulation
- 115V: 3/7 hp; 2 Amps; R290 refrigerant

Dimensions

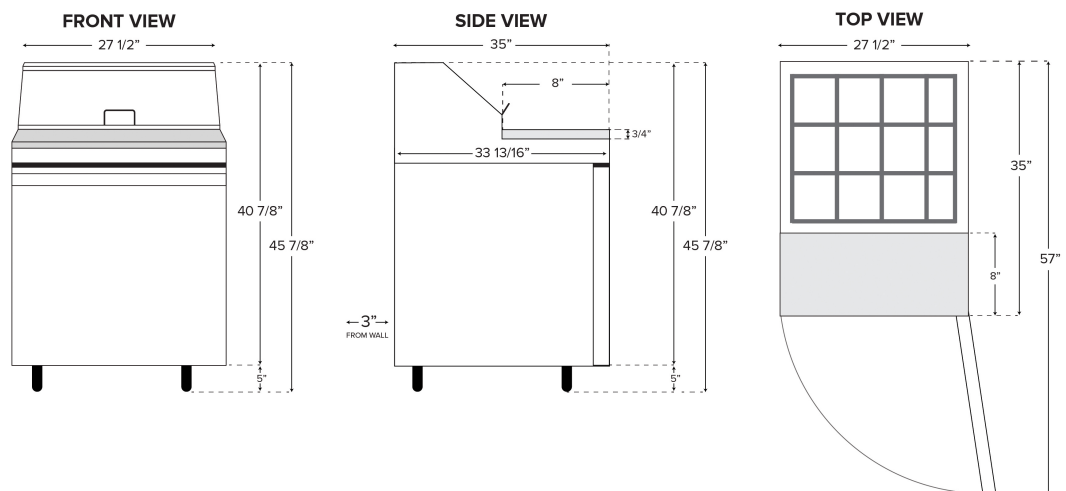

Technical Data

Cutting Board Height	3/4 Inches
Height with Lid Open	51 5/8 Inches
Interior Height	23 1/2 Inches
Work Surface Height	35 1/4 Inches
Amps	2 Amps
Hertz	60 Hertz
Phase	1 Phase
Voltage	115 Volts
1/6 Size Pan Capacity	9 Pans
1/9 Size Pan Capacity	3 Pans
Access Type	Doors
BTU (LBP)	974 BTU
Capacity	6 cu. ft.
Casters	With Casters
Compressor Location	Rear Mounted
Compressor Style	Side / Rear Breathing
Construction	Stainless Steel
Door Style	Swing
Door Type	Solid
Hinge Location	Right
Horsepower	3/7 HP
Individual Shelf Capacity	88 lb.
Number of Doors	1 Doors
Number of Shelves	1 Shelf
Plug Type	NEMA 5-15P
Refrigerant Capacity	2.8 oz.
Refrigerant Type	R-290
Style	Counter Height
Temperature Range	33 - 40 Degrees F
Top Type	Mega Top
Type	Prep Refrigeration

Certifications



ETL, US & Canada



ETL Sanitation



5-15P

OLDACH
REFRIGERATION, AIR CONDITIONING & VENTILATION SUPPLIER

www.sterlingprofessionalpr.com

